

THIS DRAWING IS A CONTROLLED DOCUMENT FOR AMP INC. IT IS SUBJECT TO CHANGE AND THE USER SHOULD BE CONTACTED FOR THE LATEST REVISION.

THIS INFORMATION IS CONFIDENTIAL AND IS DISCLOSED TO YOU ON THE CONDITION THAT YOU WILL NOT REPRODUCE, COPIY, OR TRANSMIT IT IN ANY FORM OR BY ANY MEANS WITHOUT THE WRITTEN AUTHORIZATION FROM AMP INCORPORATED, HARRISBURG, PA.

- NOTES:
- 1. ONLY THE ITEMS WITH QUANTITIES SPECIFIED ON PARTS LIST ARE USED ON THIS APPLICATOR.
 - 2. USED IN PLACE OF ITEM 38 WHEN INSULATION CRIMP IS NOT USED.
 - 3. GUARD MUST BE IN PLACE WHEN OPERATING APPLICATOR IN AMP-O-ELECTRIC PRESS.
 - 4. PARTS WITH QTY OF REF. SPECIFIED (EXCEPT ITEM 79) ARE USED ON ITEM 32.
- KEY:
- RECOMMENDED SPARE PARTS.
 - ▲ LUBRICATE DAILY USING NO. 20 MACHINE OIL.
 - GREASE LIGHTLY.

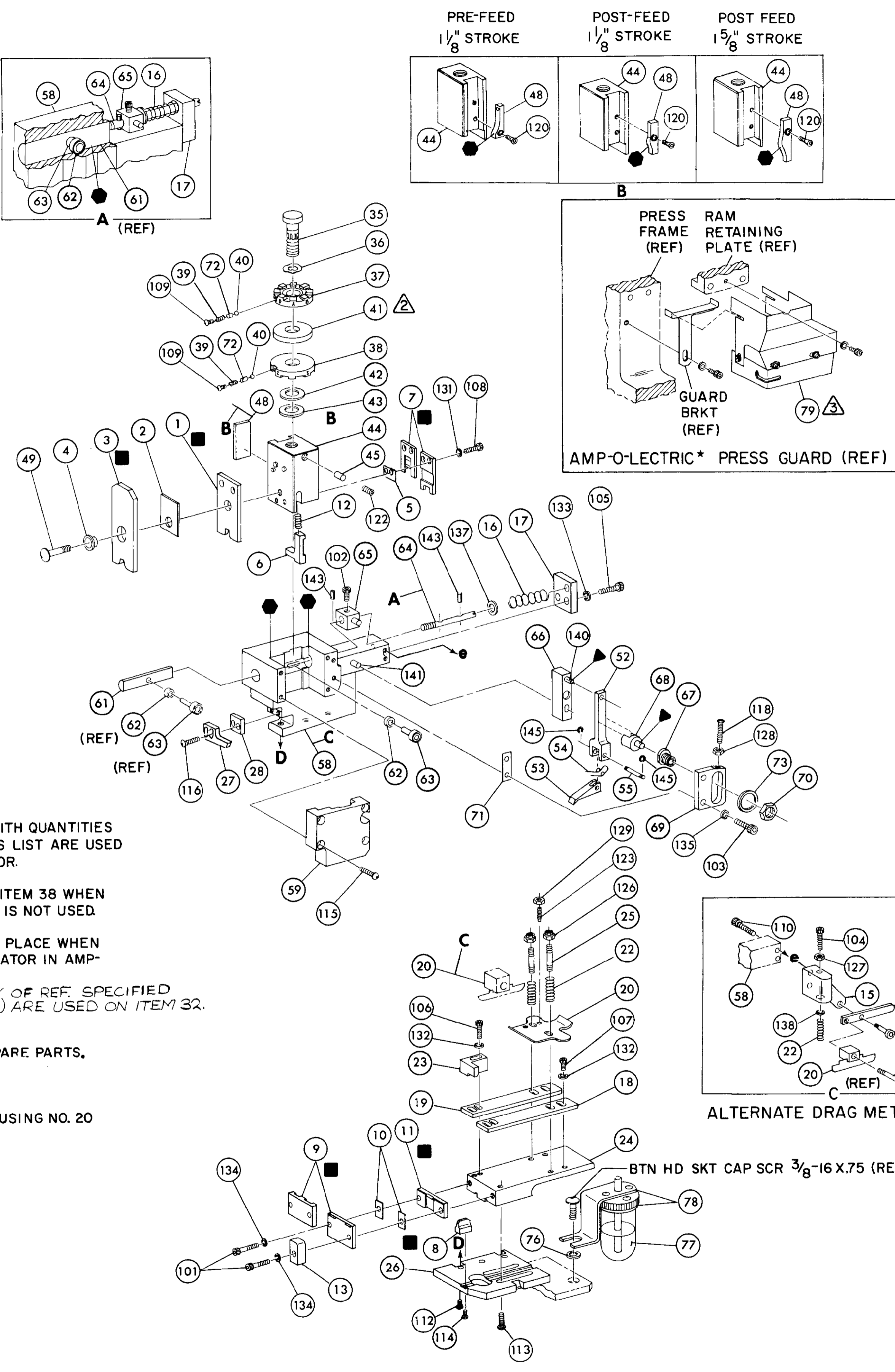

REF.	QTY	PART NO	DESCRIPTION	ITEM NO	
REF.	145	21045-3	RING, RETAINING 'C' (.187 DIA) FEED PIN	59	
REF.	144	5-21028-1	PIN, SLOT SPG (.12 DIA X .50) FD ADJ ROD	58	
REF.	143	1-21030-7	PIN, DOWEL (.187 DIA X 1.50) HOUSING	57	
REF.	142	1-21030-1	PIN, DOWEL (.187 DIA X .50) LEVER	56	
REF.	141	22260-5	WASHER, FLAT (NO 6) DRAG SPRING	55	
REF.	140	21899-4	WASHER, FLAT (5/16 DIA) SCR ADJ	54	
REF.	139	REF.	240624-1	PIN, FEED FINGER	53
REF.	138	REF.	691499-1	SPRING, FEED FINGER	52
REF.	137	REF.	240635-1	FINGER, FEED	51
REF.	136	REF.	240634-1	LEVER, TERMINAL	50
REF.	135	REF.	7-21002-9	BOLT, CRIMPER	49
REF.	134	REF.	690602-5	CAM, PRE FEED 1 1/8 STROKE	48
REF.	133	REF.	690191-1	PLUG, NYLON	47
REF.	132	REF.	455674-1	RAM	46
REF.	131	REF.	690125-1	WASHER, LAMINATED	45
REF.	130	REF.	690124-1	WASHER, RAM	44
REF.	129	REF.	23241-6	SPACER, DISC	43
REF.	128	REF.	690124-1	BALL, STEEL	42
REF.	127	REF.	22480-5	SPRING, COMPRESSION	41
REF.	126	REF.	690170-1	DISC, INSULATION	40
REF.	125	REF.	690142-1	DISC, WIRE	39
REF.	124	REF.	9-690692-9	WASHER, SPRING	38
REF.	123	REF.	22480-5	POST, RAM	37
REF.	122	REF.	690212-1	APPLICATOR, BASIC (SUB ASSY)	36
REF.	121	REF.	458980-1	SCR, BTN HD SKT CAP (6-32 X .38) CAM	35
REF.	120	REF.	2-21002-2	SCR, BTN HD SKT CAP (8-32 X .50) STRIPPER	34
REF.	119	REF.	2-21002-9	SCR, BTN HD SKT CAP (10-32 X .75) HSG CAP	33
REF.	118	REF.	22733-8	SCR, BTN HD SKT CAP (8-32 X .38) (LOC-WEL) ANVIL	32
REF.	117	REF.	3-21002-3	SCR, BTN HD SKT CAP (1/4-20 X .50) STR GDE PL	31
REF.	116	REF.	2-22733-9	SCR, BTN HD SKT CAP (1/4-20 X .75) BASE PL	30
REF.	115	REF.	2-21000-4	SCR, SKT HD CAP (6-32 X 1.00) DRAG ADAPTOR	29
REF.	114	REF.	23030-1	SCR, SKT HD CAP (6-32 X .25) (LOC-WEL) CP DISC	28
REF.	113	REF.	2-21000-6	SCR, SKT HD CAP (8-32 X .38) SHEAR BLADE	27
REF.	112	REF.	7-21000-4	SCR, SKT HD CAP (8-32 X .31) STRIP GUIDE	26
REF.	111	REF.	2-21000-8	SCR, SKT HD CAP (8-32 X .62) STRIP GUIDE	25
REF.	110	REF.	3-21000-7	SCR, SKT HD CAP (10-32 X .75) FD ROD GUIDE	24
REF.	109	REF.	3-21000-9	SCR, SKT HD CAP (10-32 X 1.00) DRAG SPRING	23
REF.	108	REF.	3-21000-6	SCR, SKT HD CAP (10-32 X .62) FD ADJ PLATE	22
REF.	107	REF.	3-21000-4	SCR, SKT HD CAP (10-32 X .38) PIVOT BLK	21
REF.	106	REF.	3-21000-8	SCR, SKT HD CAP (10-32 X .88) SHEAR PLATE	20
REF.	105	REF.	455745-1	GUARD, WINDOW	19
REF.	104	REF.	465184-9	LUBRICATOR ASSY	18
REF.	103	REF.	455985-1	OIL, LUBRICATING	17
REF.	102	REF.	454406-1	SPACER, LUB BRACKET	16
REF.	101	REF.	458109-1	WASHER, FLAT (SPECIAL)	15
REF.	79	REF.	690603-1	SPRING, ASSIST	14
REF.	78	REF.	690517-1	SPACER	13
REF.	77	REF.	22594-8	NUT, HEX	12
REF.	76	REF.	240628-1	PLATE, ADJ	11
REF.	75	REF.	240626-1	SHAFT, PIVOT	10
REF.	74	REF.	240633-1	BUSHING	9
REF.	73	REF.	455680-1	LEVER, INTERMEDIATE	8
REF.	72	REF.	240629-1	BLOCK, PIVOT	7
REF.	71	REF.	240632-2	SCREW, ADJ	6
REF.	70	REF.	240659-3	PIN, CAM ROLLER	5
REF.	69	REF.	240658-1	CAM, ROLLER	4
REF.	68	REF.	454398-1	ROD, FEED	3
REF.	67	REF.			2
REF.	66	REF.			1

REVISION RECORD		REVISION RECORD	
P.F. LTR	REVISION RECORD	P.F. LTR	REVISION RECORD

CRIMPING DATA				APPLICATOR WILL APPLY	
PAD LTR	CRIMP HEIGHT	WIRE SIZE	WIRE STRIP LENGTH		
A	.053	18			36068
B	.047	20			62886
C	.044	22			63021
D	NOT USED				
CRIMP	SIZE	TYPE	FEED	APPL INST	

REMARKS	NO	REV

APPL USED ON MACHINE PART NO	MACH SERIAL NO	DISTRIBUTION
CUSTOMER NAME	APPL SERIAL NO	ORIGINAL
ADDRESS	PURCHASE ORDER	CUSTOMER COPY
CITY	ENG APP	FIELD ENG COPY

WIRE RANGE	INSULATION RANGE	PRESS NO
18	.090-.130	565435-5

REMARKS: AMP-O-ELECTRIC PRE-FEED

I.D. PLATE (REF) 461264-1

E1	015A-0485-99	TM	12-90	SET UP PAGE 10-1
E	0150-6815-96	WB	12-90	458638-1 593A
D	EN 161355	WB	11-89	DR 9/27/97 AP 10/1/04
V	0	REV PER ECU R-5503	12/02-10-04	DR 11/28/04 AP 10/1/04
V	0	REV PER ECU R-3858	08/11/03	DR 11/28/04 AP 10/1/04
V	0	REV PER ECU R-3949	08/11/03	DR 11/28/04 AP 10/1/04
V	0	REV PER ECU R-3341	11/12/02	DR 11/28/04 AP 10/1/04

LOG A D NO 466838-2 REV E1

NAME MINIATURE QUICK CHANGE APPLICATOR

END FEED (.110 FASTON)