

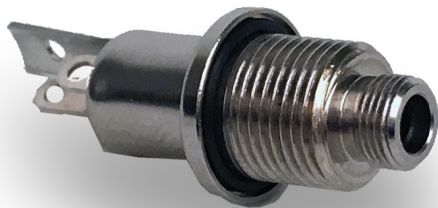

NEW PRODUCT BULLETIN 638

# 3.5MM PANEL MOUNT STEREO JACKS

SEALED  
FLUSH MOUNT  
STANDARD



**Switchcraft**<sup>®</sup>  
**CONXALL**<sup>®</sup>

HARSH ENVIRONMENT CONNECTIVITY SOLUTIONS

5555 N ELSTON AVE | CHICAGO, IL | P: 773.792.2700 | F: 773.792.2129 | [WWW.SWITCHCRAFT.COM](http://WWW.SWITCHCRAFT.COM)

## LOCKING

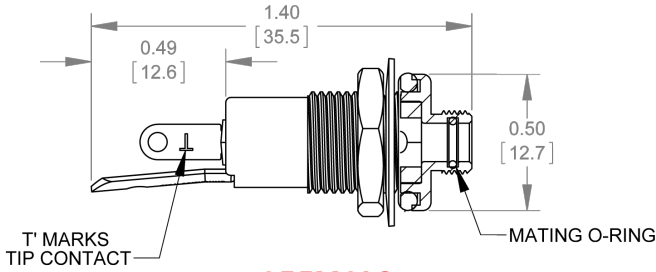

**35FM3LS**

- Mates with any standard 3.5mm plug
- Sealed to IP66 when mated
- Threaded bushing for use with locking plugs
- Rated for 5,000 insertions/ withdrawals minimum
- 3 conductor open circuit
- Durable nickel plated copper housing
- High quality beryllium copper contacts
- Front or rear mount styles available

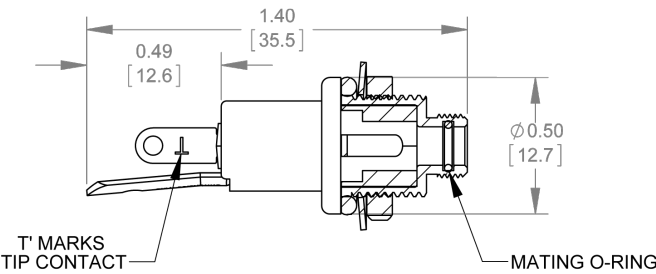

**35RM3LS**

### Part Number Logic

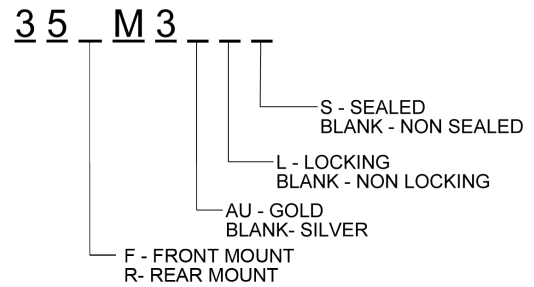

## FLUSH MOUNT

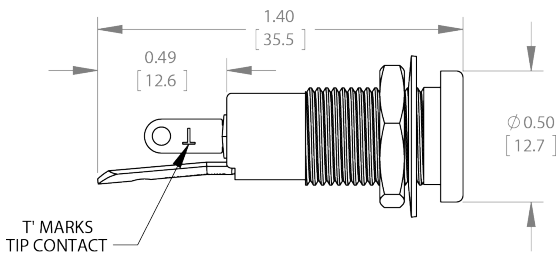

**35FM3**

- Mates with any standard 3.5mm plug
- Front mount design mounts flush with panel
- Rated for 5,000 insertion/ withdrawals minimum
- 3 conductor open circuit
- Durable nickel plated copper housing
- Silver plated Beryllium Copper contacts
- Also available sealed (add "S" to part number)

## COMPACT REAR MOUNT

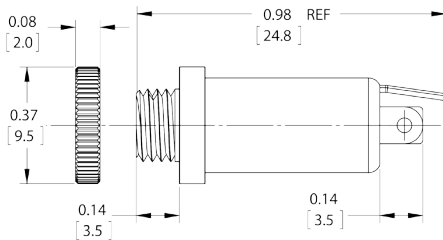

**35PRM3**

- Mates with any standard 3.5mm plug
- Compact design
- 3 conductor open circuit
- Nickel plated brass housing
- Nickel plated brass contacts

