

MODELS:

PDU3VSR3L2120, PDU3VSR10L2120

3-Phase Switched Rackmount PDU



208V
3-Phase Input



L21-20P Plug



208V Single-Phase Output



24 Outlets



5.7kW

5.7kW Load Capacity



Multimode Load Meter



Network Interface



0U Rackmount



Toolless Mounting Buttons

- A** Digital Load Meter
- B** C13 and C19 Outlets with On/Off LEDs
- C** Removable Cord Retention Brackets
- D** Removable Mounting Brackets
- E** Toolless Mounting Buttons with Removable 90° Rotation Brackets
- F** PDU3VSR3L2120: 3-ft. Input Power Cord
PDU10VSR10L2120: 10-ft. Input Power Cord
- G** L21-20P Twist-Lock Input Plug
- H** Durable Metal Case
- I** Network Interface
- J** RJ45 Ethernet Jack
- K** Manual Configuration Port
- L** Environmental Monitoring Port
- M** Network Interface Reset Button
- N** Modem Port (For Future Use)

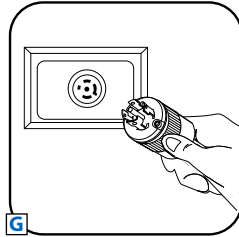

AC Input Connection: Insert L21-20P twist-lock plug into compatible L21-20R utility, generator or UPS outlet.

Also Includes: Cable Ties, Owner's Manual, PowerAlert Software CD-ROM

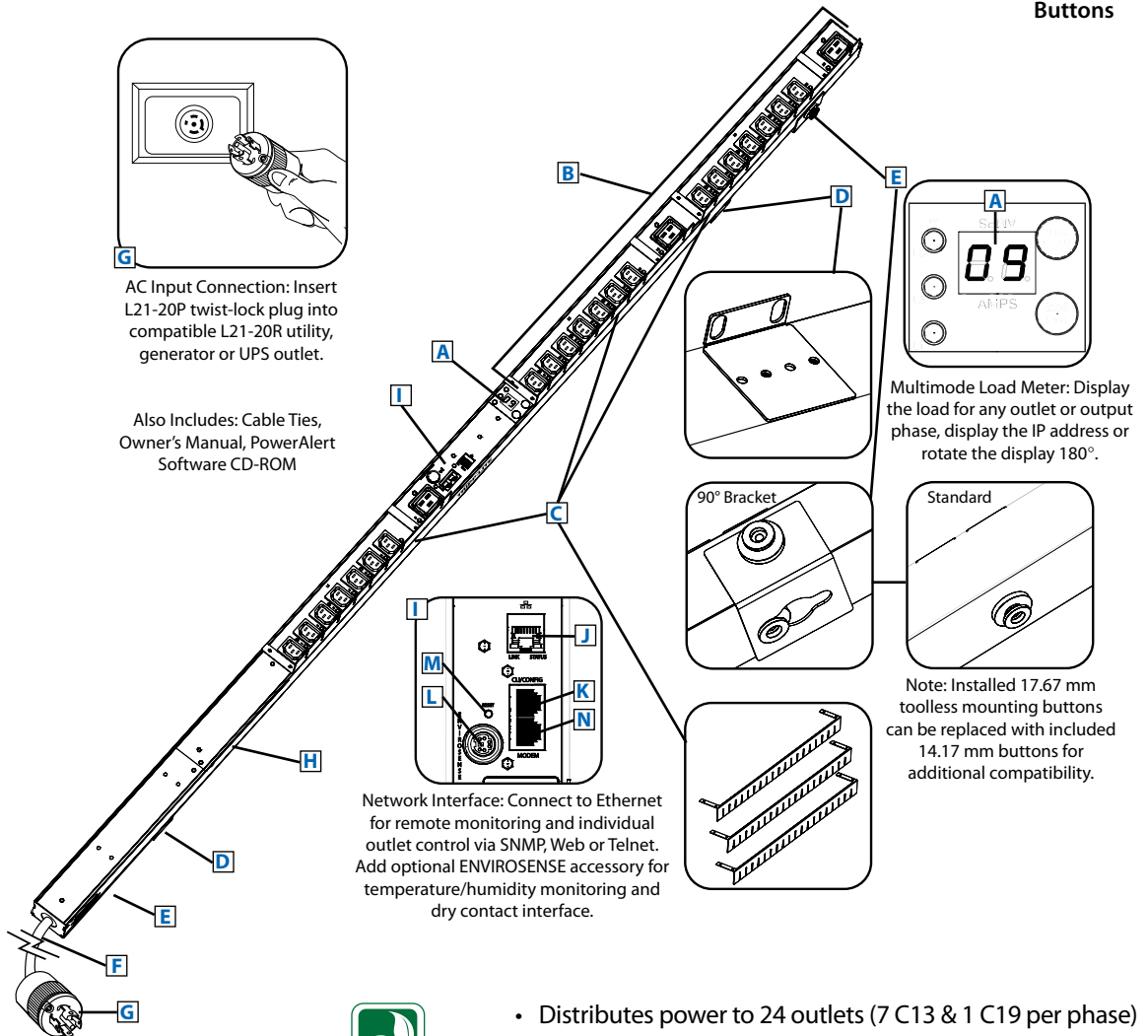

Multimode Load Meter: Display the load for any outlet or output phase, display the IP address or rotate the display 180°.

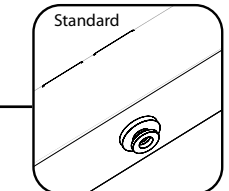
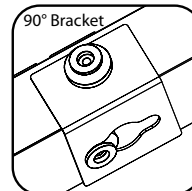
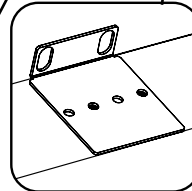

Note: Installed 17.67 mm toolless mounting buttons can be replaced with included 14.17 mm buttons for additional compatibility.

Network Interface: Connect to Ethernet for remote monitoring and individual outlet control via SNMP, Web or Telnet. Add optional ENVIROSENSE accessory for temperature/humidity monitoring and dry contact interface.

Specifications

Models	PDU3VSR3L2120, PDU3VSR10L2120
Voltage	208V (3-Phase Input/Single-Phase Output)
Frequency	50/60Hz
Load Capacity	5.7kW
Input Plug	L21-20P
Input Cord Length	PDU3VSR3L2120: 3 ft., PDU3VSR10L2120: 10 ft.
Outlets	24 (21 C13 / 3 C19)
Primary Mounting Option	0U (Vertical) Rackmount
Unit Weight & Dimensions	PDU3VSR3L2120: 11.7 lbs / 70 x 2.20 x 1.73 in., PDU3VSR10L2120: 13.2 lbs / 70 x 2.20 x 1.73 in. <i>See next page for detailed unit measurements.</i>
Certifications	Tested to UL 60950-1 (US & Canada), NOM (Mexico), FCC Class A

Tripp Lite has a policy of continuous improvement. Specifications are subject to change without notice.



- Distributes power to 24 outlets (7 C13 & 1 C19 per phase)
- Remote monitoring and control via SNMP, Web or Telnet
- Displays load for *any outlet or output phase* in real time
- Perfect for rackmount server, network and telecom applications

SEE NEXT PAGE FOR DETAILED UNIT MEASUREMENTS



1111 W. 35th Street
Chicago, IL 60609 USA
773.869.1234
www.tripplite.com

