

REV
NC 0460-245-12**

REVISIONS			
SYM	DESCRIPTION	DATE	APPROVED
NC	NEW RELEASE PER E.O. P19398	11-17-06	<i>RDC</i>

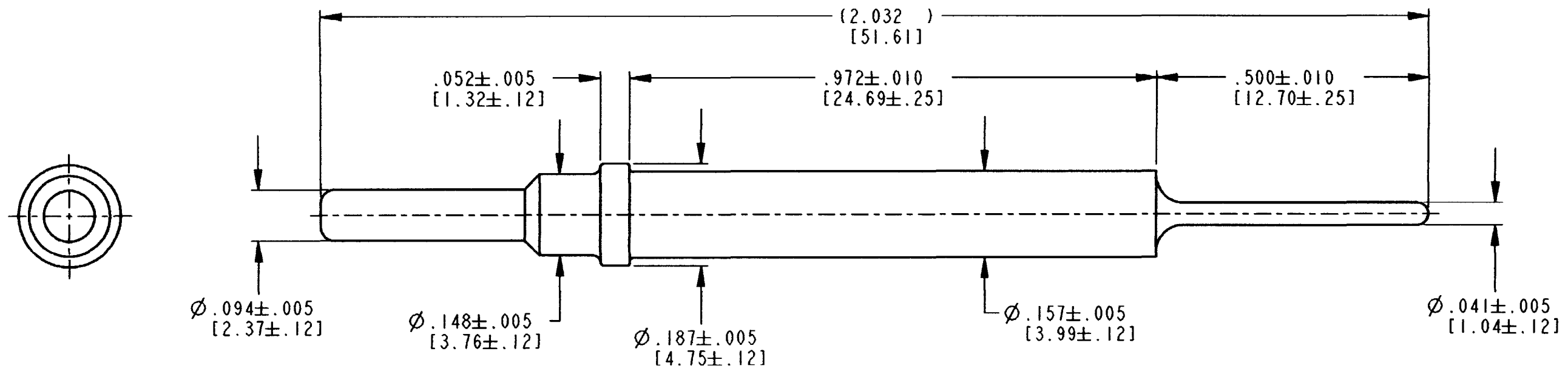

- NOTES:
1. DIMENSIONS ARE IN INCHES [mm].
 2. WHEN ** = 31: PLATING IS GOLD.
WHEN ** = 90: PLATING IS TIN.
 3. FOR CONTACT APPLICATION, SEE DRAWING 0425-202-0000.

SIGNATURE & DATE	
DR	<i>J. APOSTOL</i> 25OCT2006
CHK	<i>S. [Signature]</i> 11/02/06
PE	<i>D. [Signature]</i> 10/21/06
APPD	<i>R. [Signature]</i> 11-17-06
SCALE	NONE
WT	

CONTACT PIN
SIZE 12
EXTENSION

ENVELOPE

EP	MATL. CODE
The Deutch Company	DEUTSCH I.P.D. 3850 INDUSTRIAL AVE. HEMET, CALIF. 92545
B	0460-245-12**
DWG SIZE	CODE 11139 SHEET OF