

Low to Mid Voltage Solid Aluminum Conductive Polymer Surface Mount Capacitors

Sample Kit Contents

| KEMET Part Number | VDC | VDC Surge Voltage | Rated Capacitance 120 Hz 20°C (µF) | Case Size D x L (mm) | ESR 100 kHz 20°C (mΩ) | RC 100 kHz 105°C (mA) | LC 20°C 2 Minutes (µA) | Quantity |
|--------------------|-----|-------------------|------------------------------------|----------------------|-----------------------|-----------------------|------------------------|----------|
| A765EB397M0ELAE020 | 2.5 | 2.9 | 390 | 6.3 x 5.7 | 20 | 2,800 | 300 | 5 |
| A765KN108M0ELAE012 | 2.5 | 2.9 | 1000 | 8 x 9.7 | 12 | 4,260 | 500 | 5 |
| A765BC107M0JLAE025 | 6.3 | 7.2 | 100 | 5 x 6 | 25 | 1,700 | 300 | 5 |
| A765BG227M0JLAE020 | 6.3 | 7.2 | 220 | 5 x 7 | 20 | 2,700 | 300 | 5 |
| A765EB227M0JLAE020 | 6.3 | 7.2 | 220 | 6.3 x 5.7 | 20 | 2,800 | 300 | 5 |
| A765KH477M0JLAE016 | 6.3 | 7.2 | 470 | 8 x 7.5 | 16 | 3,220 | 592 | 5 |
| A765KN687M0JLAE012 | 6.3 | 7.2 | 680 | 8 x 9.7 | 12 | 5,000 | 857 | 5 |
| A765MU158M0JLAE010 | 6.3 | 7.2 | 1,500 | 10 x 12.6 | 10 | 4,100 | 1,890 | 5 |
| A765EB157M1ALAE022 | 10 | 11.5 | 150 | 6.3 x 5.7 | 22 | 2,320 | 300 | 5 |
| A765KN277M1ALAE020 | 10 | 11.5 | 270 | 8 x 9.7 | 20 | 3,600 | 540 | 5 |
| A765MU687M1ALAE013 | 10 | 11.5 | 680 | 10 x 12.6 | 13 | 3,800 | 1,360 | 5 |
| A765EB107M1CLAE025 | 16 | 18.4 | 100 | 6.3 x 5.7 | 25 | 2,500 | 320 | 5 |
| A765EG157M1CLAE027 | 16 | 18.4 | 150 | 6.3 x 7 | 27 | 2,530 | 480 | 5 |
| A765KN227M1CLAE016 | 16 | 18.4 | 220 | 8 x 9.7 | 16 | 3,700 | 704 | 5 |
| A765KN277M1CLAE016 | 16 | 18.4 | 270 | 8 x 9.7 | 16 | 3,890 | 864 | 5 |
| A765KN337M1CLAE016 | 16 | 18.4 | 330 | 8 x 9.7 | 16 | 3,890 | 1,056 | 5 |
| A765MU108M1CLAE018 | 16 | 18.4 | 1000 | 10 x 12.6 | 18 | 4,300 | 3,200 | 5 |
| A765EB476M1ELAE040 | 25 | 28.7 | 47 | 6.3 x 5.7 | 40 | 1,200 | 300 | 5 |
| A765KN826M1ELAE029 | 25 | 28.7 | 82 | 8 x 9.7 | 29 | 2,700 | 410 | 5 |
| A765KN107M1ELAE024 | 25 | 28.7 | 100 | 8 x 9.7 | 24 | 3,300 | 500 | 5 |
| A765MU157M1ELAE050 | 25 | 28.7 | 150 | 10 x 12.6 | 50 | 3,800 | 750 | 5 |
| A765MU227M1ELAE050 | 25 | 28.7 | 220 | 10 x 12.6 | 50 | 3,800 | 1,100 | 5 |
| A765MU337M1ELAE020 | 25 | 28.7 | 330 | 10 x 12.6 | 20 | 2,890 | 1,650 | 5 |

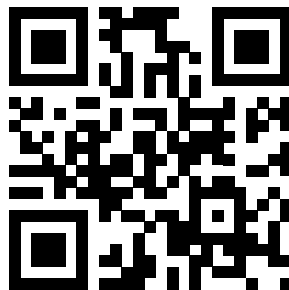

www.kemet.com/A765

Dimensions – Millimeters

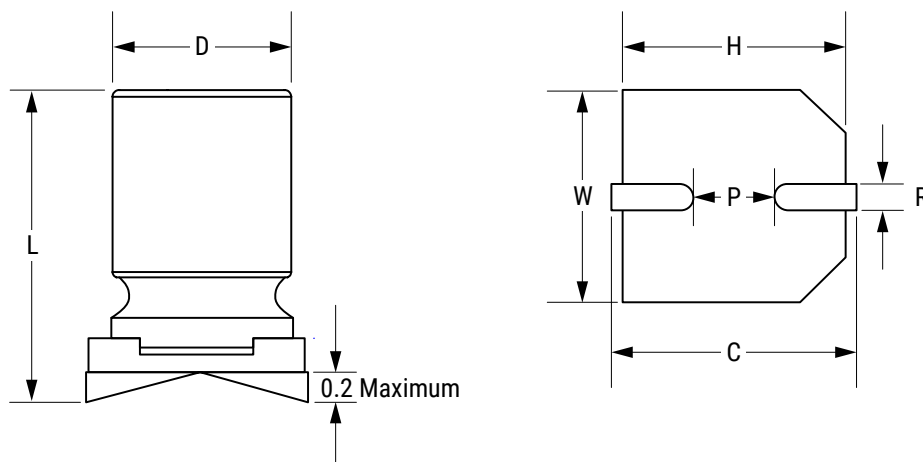

| Size Code | D | | L | | W | | H | | C | | R | P |
|-----------|---------|-----------|---------|-----------|---------|-----------|---------|-----------|---------|-----------|-----------|---------|
| | Nominal | Tolerance | Nominal | Tolerance | Nominal | Tolerance | Nominal | Tolerance | Nominal | Tolerance | Nominal | Nominal |
| BC | 5 | ±0.5 | 6 | ±0.3 | 5.3 | ±0.2 | 5.3 | ±0.2 | 6.0 | ±0.2 | 0.5 - 0.8 | 1.4 |
| BG | 5 | ±0.5 | 7 | ±0.3 | 5.3 | ±0.2 | 5.3 | ±0.2 | 6.0 | ±0.2 | 0.5 - 0.8 | 1.4 |
| EB | 6.3 | ±0.5 | 5.7 | ±0.3 | 6.6 | ±0.2 | 6.6 | ±0.2 | 7.3 | ±0.2 | 0.5 - 0.8 | 2.1 |
| EG | 6.3 | ±0.5 | 7 | ±0.3 | 6.6 | ±0.2 | 6.6 | ±0.2 | 7.3 | ±0.2 | 0.5 - 0.8 | 2.1 |
| EK | 6.3 | ±0.5 | 8 | ±0.3 | 6.6 | ±0.2 | 6.6 | ±0.2 | 7.3 | ±0.2 | 0.5 - 0.8 | 2.1 |
| EN | 6.3 | ±0.5 | 9.7 | ±0.3 | 6.6 | ±0.2 | 6.6 | ±0.2 | 7.3 | ±0.2 | 0.5 - 0.8 | 2.1 |
| KH | 8 | ±0.5 | 7.5 | ±0.3 | 8.3 | ±0.2 | 8.3 | ±0.2 | 9.0 | ±0.2 | 0.8 - 1.1 | 3.2 |
| KN | 8 | ±0.5 | 9.7 | ±0.3 | 8.3 | ±0.2 | 8.3 | ±0.2 | 9.0 | ±0.2 | 0.8 - 1.1 | 3.2 |
| MU | 10 | ±0.5 | 12.6 | ±0.3 | 10.3 | ±0.2 | 10.3 | ±0.2 | 11.0 | ±0.2 | 0.8 - 1.1 | 4.6 |