

|     |      |           |     |  |           |     |      |
|-----|------|-----------|-----|--|-----------|-----|------|
| LOC | DIST | REVISIONS |     |  | DATE      | DWN | APVD |
| A   | -    | P         | LTR | DESCRIPTION                                    |           |     |      |
|     |      | B         |     | PLATING CHANGED TO PdNi+GOLD FLASH AT AREA "F" | 02JUN2014 | PS  | JK   |

| POS. | L±0.5  | PART NO.      |   |
|------|--------|---------------|---|
| -    | -      | -             | - |
| 2    | 5.08   | -             | 3 |
| 3    | 7.62   | -             | 3 |
| 4    | 10.16  | 966 575 -4    |   |
| 5    | 12.70  | 966 575 -5    |   |
| 6    | 15.24  | -             | 3 |
| 7    | 17.78  | 966 575 -7    |   |
| 8    | 20.32  | 966 575 -8    |   |
| 9    | 22.86  | -             | 3 |
| 10   | 25.40  | 1- 966 575 -0 |   |
| 11   | 27.94  | 1- 966 575 -1 |   |
| 12   | 30.48  | 1- 966 575 -2 |   |
| 13   | 33.02  | 1- 966 575 -3 |   |
| 14   | 35.56  | 1- 966 575 -4 | 3 |
| 15   | 38.10  | 1- 966 575 -5 |   |
| 16   | 40.64  | 1- 966 575 -6 |   |
| 17   | 43.18  | 1- 966 575 -7 |   |
| 18   | 45.72  | 1- 966 575 -8 |   |
| 19   | 48.26  | 1- 966 575 -9 |   |
| 20   | 50.80  | 2- 966 575 -0 |   |
| 21   | 53.34  | 2- 966 575 -1 | 3 |
| 22   | 55.88  | 2- 966 575 -2 | 3 |
| 23   | 58.42  | 2- 966 575 -3 | 3 |
| 24   | 60.96  | 2- 966 575 -4 | 3 |
| 25   | 63.50  | 2- 966 575 -5 | 3 |
| 26   | 66.04  | 2- 966 575 -6 | 3 |
| 27   | 68.58  | 2- 966 575 -7 | 3 |
| 28   | 71.12  | 2- 966 575 -8 | 3 |
| 29   | 73.66  | 2- 966 575 -9 | 3 |
| 30   | 76.20  | 3- 966 575 -0 | 3 |
| 31   | 78.74  | 3- 966 575 -1 | 3 |
| 32   | 81.28  | 3- 966 575 -2 | 3 |
| 33   | 83.82  | 3- 966 575 -3 | 3 |
| 34   | 86.36  | 3- 966 575 -4 | 3 |
| 35   | 88.90  | 3- 966 575 -5 | 3 |
| 36   | 91.44  | 3- 966 575 -6 | 3 |
| 37   | 93.98  | 3- 966 575 -7 | 3 |
| 38   | 96.52  | 3- 966 575 -8 | 3 |
| 39   | 99.06  | 3- 966 575 -9 | 3 |
| 40   | 101.60 | 4- 966 575 -0 | 3 |
| 41   | 104.14 | 4- 966 575 -1 | 3 |
| 42   | 106.68 | 4- 966 575 -2 | 3 |
| 43   | 109.22 | 4- 966 575 -3 | 3 |
| 44   | 111.76 | 4- 966 575 -4 | 3 |
| 45   | 114.30 | 4- 966 575 -5 | 3 |
| 46   | 116.84 | 4- 966 575 -6 | 3 |
| 47   | 119.38 | 4- 966 575 -7 | 3 |
| 48   | 121.92 | 4- 966 575 -8 | 3 |
| 49   | 124.46 | 4- 966 575 -9 | 3 |
| 50   | 127.00 | 5- 966 575 -0 | 3 |

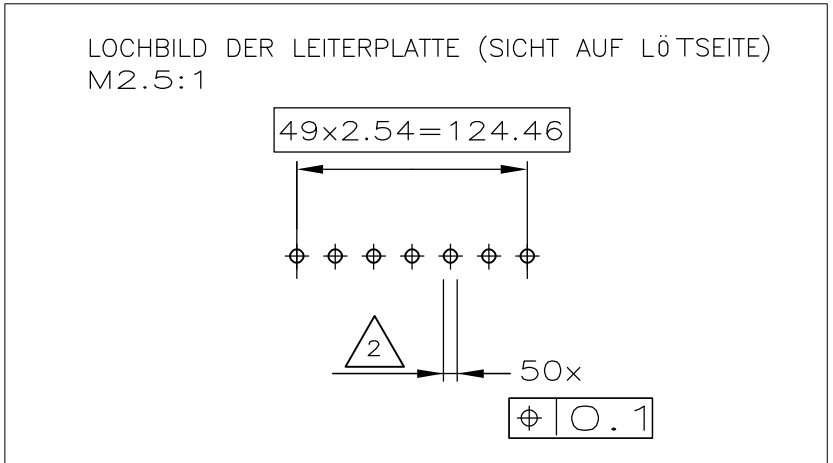
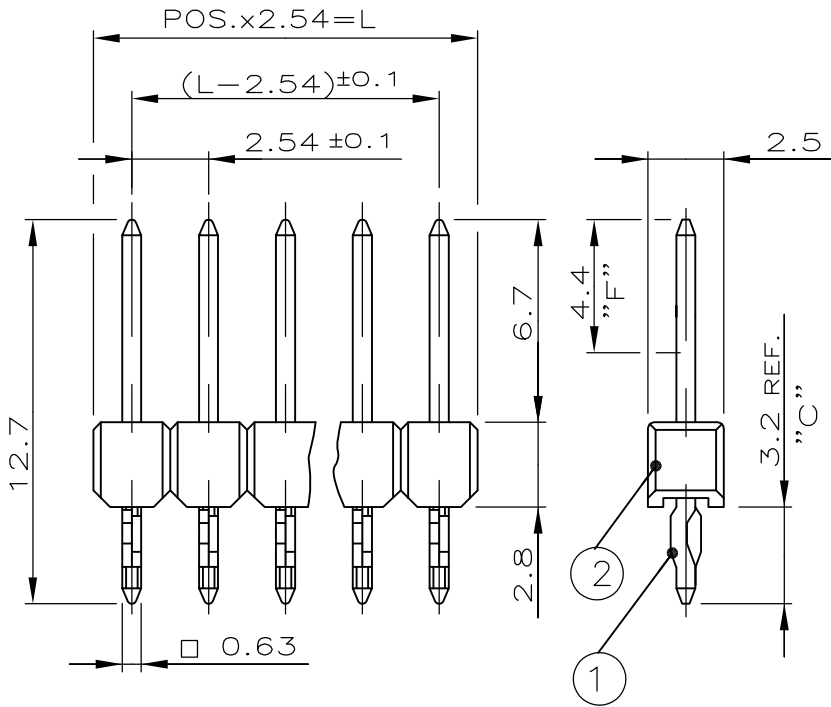

- 3 OBSOLETE PARTS; OBSOLETE CIS STREAMLINING PER D.RENAUD/D.SINISI
- 2 GEBOHRTES LOCH 1.0 ±0.025 mm  
Cu DICKE 25-50µm  
Sn DICKE min. 4µm  
FERTIGE BOHRUNG 0.9 ±0.07mm
- 1 MIN 0.7µm PdNi + MIN 0.1µm GOLD FLASH IN ZONE "F"  
MIN 2.5µm TIN OVER 1.27µm NICKEL IN ZONE "C"

| ITEM NO. | PART DESCRIPTION | MATERIAL | FINISH |
|----------|------------------|----------|--------|
| 1        | CONTACT PIN      | CuSn     | 1      |
| 2        | HOUSING          | PBT      | GREEN  |

RELEASED FOR PUBLICATION

ALL RIGHTS RESERVED.

By -

COPYRIGHT

DIMENSIONS:

mm

TOLERANCES UNLESS OTHERWISE SPECIFIED:  
± 0.2mm

|        |     |
|--------|-----|
| 0 PLC  | ± - |
| 1 PLC  | ± - |
| 2 PLC  | ± - |
| 3 PLC  | ± - |
| 4 PLC  | ± - |
| ANGLES | ± - |

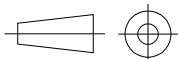

|                           |  |                       |                        |
|---------------------------|--|-----------------------|------------------------|
| DWN<br>A.HO               | 01.06.94   | MATERIAL<br>SEE TABLE | FINISH<br>SEE TABLE    |
| CHK<br>M.SCHAARSCHMIDT    | 01.06.94   |                       |                        |
| APVD<br>-                 | -  |                       |                        |
| PRODUCT SPEC<br>108-18012 | NAME<br>AMPMODU II ACTION PIN HEADER<br>SINGLE ROW |                       |                        |
| APPLICATION SPEC<br>-     | SIZE<br>A4   | CAGE CODE<br>00779    | DRAWING NO<br>C-966575 |
| WEIGHT<br>-               | RESTRICTED TO<br>-                                 |                       | SCALE<br>4:1           |
| CUSTOMER DRAWING          |  | SHEET<br>1 OF 1       | REV<br>B               |