

CUSTOMER TERMINAL	RoHS	LEAD(Pb)-FREE
Sn96%, Ag4%	Yes	Yes

more than you expect

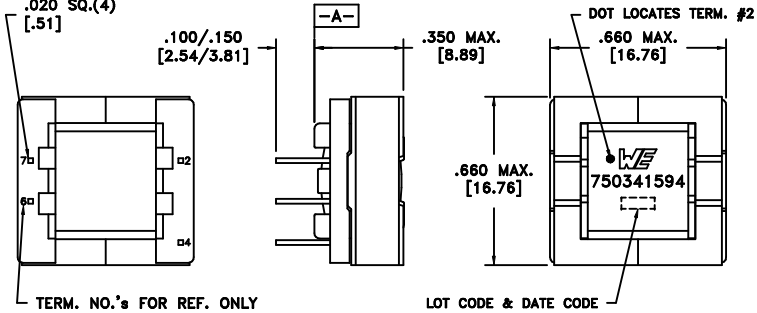

PART MUST INSERT FULLY TO SURFACE A IN RECOMMENDED GRID .020 SQ.(4) [.51]



TERM. NO.'s FOR REF. ONLY

LOT CODE & DATE CODE

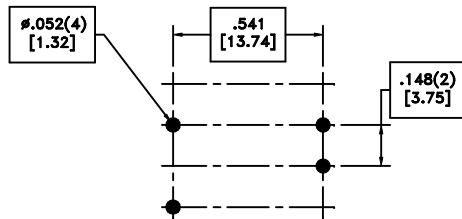
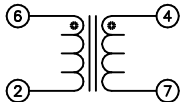

RECOMMENDED P.C. PATTERN, COMPONENT SIDE

ELECTRICAL SPECIFICATIONS @ 25°C unless otherwise noted:

PARAMETER	TEST CONDITIONS	VALUE
D.C. RESISTANCE	6-2 @20°C	0.717 ohms max.
D.C. RESISTANCE	4-7 @20°C	0.272 ohms max.
INDUCTANCE	6-2 20kHz, 1.0VAC, Ls	350.0uH ±5%
DIELECTRIC	2-4 1800VAC, 1 second	-
TURNS RATIO	(6-2):(4-7)	6.67:1, ±2%

GENERAL SPECIFICATIONS:

OPERATING TEMPERATURE RANGE: -40°C to +125°C including temp rise.

Wire insulation & RoHS status not affected by wire color.
 Wire insulation color may vary depending on availability.

REV.	DATE	Packaging Specifications Method: Tray PKG-0204 www.we-online.com/midcom		Tolerances unless otherwise specified: Angles: ±1° Decimals: ±.005 [.13] Fractions: ±1/64 Footprint: ±.001 [.03]	DRAWING TITLE INDUCTOR	PART NO. 750341594
6A	2/13	SEE REVISION SHEET FOR REVISION LEVEL	CONVENTION PLACEMENT	This drawing is dual dimensioned. Dimensions in brackets are in millimeters.	eiSos p/n: 750341594	SPECIFICATION SHEET 1 OF 1