

DRAWINGS MADE IN AMERICAN PROJECTION

Lot **G** **14** **B**

©1971 BY AMP INCORPORATED. ALL RIGHTS RESERVED. AMP PRODUCTS COVERED BY PATENTS AND/OR PATENTS PENDING.

REVISIONS			
LTR	DESCRIPTION	DATE	APPROVED
0	NPS 70-0619 (REV 1)	2-15-71	PCY
A	REV PER ECN P-6815	4-25-72	Jme
B	REMOVED ENG. CONT. NPS 70-0619 (REV 2)	6-21-72	Jme

52752

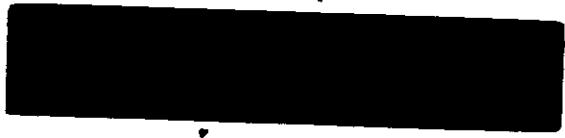
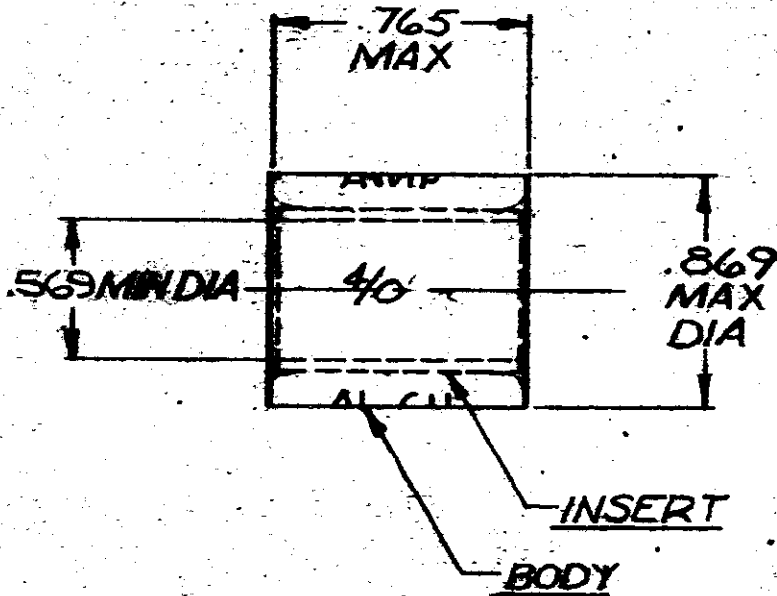

1	WIRE SPLICE	52752	INSERT: BRASS (MIL-C-50) TIN PL (MIL-T-10727) BODY: COPPER (QQ-C-576) TIN PL (MIL-T-10727) MATERIAL & FINISH
QTY	DESCRIPTION	PART NO.	

UNLESS OTHERWISE SPECIFIED DIMENSIONS ARE IN INCHES TOLERANCES ON: DECIMALS ±.008 ANGLES ±5°	CONTRACT NO.	AMP INCORPORATED HARRISBURG, PENNSYLVANIA
	DR. <i>W. J. Miller</i> 2-8-71	
MATERIAL SEE TABLE	CHK. <i>PCY</i> 2-15-71	NAME WIRE SPLICE
	APPRO. <i>Swabel</i> 2-18-71	COPALUM-PARALLEL-STRANDED/SOLID WIRE SIZE: 4/0
	REL. <i>H. Young</i> 2-18-71	SIZE A
	DESIGN APPD.	CODE IDENT NO. 00779
OTHER APPD.	NUMBER 52752	SCALE NTS
		SHEET 1 OF 1