

LOC	DIST	P	F	LTR	DESCRIPTION	DATE	APPROVED
G	14			C	REVISED & REDRAWN PER G-5803	6/12/92	DKS / AJK

THIS DRAWING IS UNPUBLISHED. BY AMP INCORPORATED. ALL INTERNATIONAL RIGHTS RESERVED. © COPYRIGHT 19

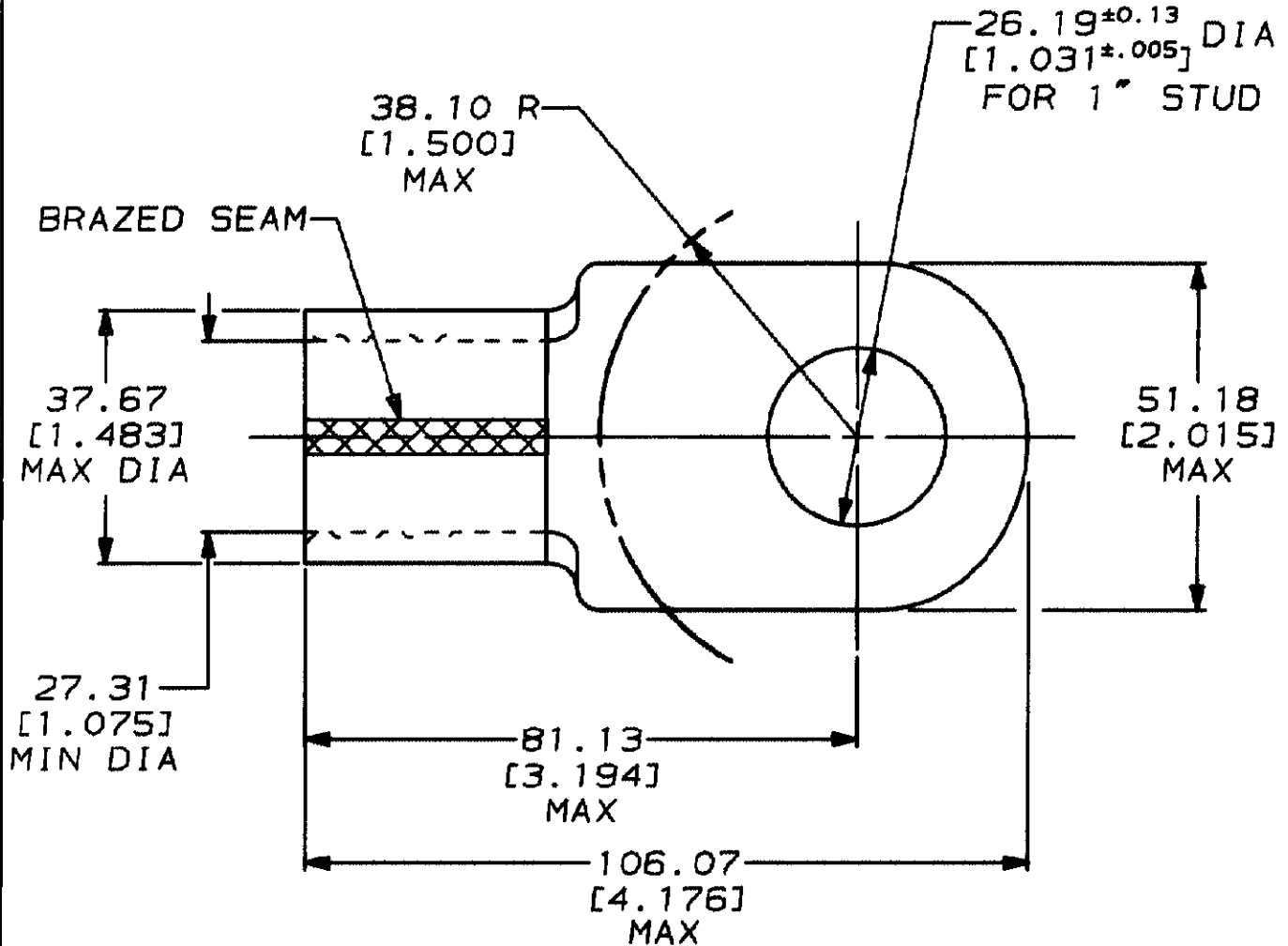

322273  
PART NO

DO NOT SCALE PRINT. UNLESS SPECIFIED DIMENSIONS IN mm [IN] TOLERANCES ON:  
 2 PLC DEC ± 0.20 [.008]  
 3 PLC DEC ± -  
 ANGLES ± -  
 MATERIAL  
 COPPER ASTM B-152 ANNEALED  
 FINISH  
 TIN PLATE  
 0.00254 [.000100] MIN THK PER MIL-T-10727

DR 6/12/92 DK SCHRUM  
 CHK 6/26/92 RD HEIN  
 APPD 6/26/92 AJ KAUFMAN  
 APPD 6/26/92 CR RHOADS  
 PRODUCT SPEC -  
 APPLICATION SPEC -  
 WEIGHT -

**AMP** AMP Incorporated  
 Harrisburg, PA 17105-3608

NAME  
 TERMINAL, RING TONGUE, SOLISTRAND™  
 WIRE SIZE: 253.0-304.0mm<sup>2</sup> [500-600] MCM

SIZE <b>A</b>	CAGE CODE 00779	DRAWING NO <b>C-322273</b>
SCALE 1:1	SHEET 1 OF 1	