

SUGGESTED PANEL CUTOUT

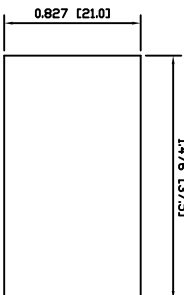

MATERIALS

BODY:
Polyamide 6/6 (PA66), UL94 V-2

ACTUATOR:
Polyamide 6/6 (PA66), UL94 V-2

SEALING MEMBRANE:
Polyvinyl Chloride (PVC)

SPRING:
Phono wire

MOBILE CONTACT BAR:
Copper

CONTACT PADS:
Silver Clad Copper

RIFETS:
Copper

TERMINALS:
Brass

SPECIFICATIONS

FUNCTION:
2PTT OFF-ON

RATINGS:
ANSI/UL 508 and CAN/CSA C22.2 No.14 (E198908):
20A 125VAC [cULRu]
15A 277VAC [cULRu]
2HP 110/250VAC [cULRu]

CONTACT RESISTANCE:
Initial: 50mΩ Max.
Electrical Life: 6,000 Cycles [cULRu]

TEMPERATURE:
Operating: -20°C to 55°C [cULRu]

INGRESS PROTECTION:
IP54



COLORS AND MARKINGS

BODY COLOR:
Black

ACTUATOR COLOR:
Black

MARKING:
None

MARKING COLOR:
None

SCHEMATIC

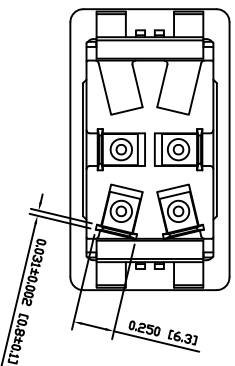
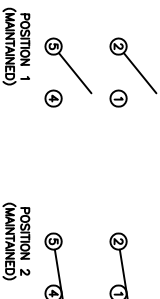

ACTUATOR BODY	REV.	DATE	BY
B	10/09/28	CAB	
A	09/06/15	CAB	
C	10/03/01	CAB	

THE INFORMATION CONTAINED IN THIS DOCUMENT IS PROPRIETARY TO E-SWITCH AND IS NOT TO BE COPIED OR TRANSMITTED

REV.	DESCRIPTION
A	
B	

CORRECTED SPECIFICATIONS
INITIAL RELEASE
DESCRIPTION

REV.	DATE	BY
A	09/12/09	CAB
B	09/08/08	CAB

DIMENSIONS
INCHES [MILLIMETERS]
GENERAL TOLERANCES ±0.008 [±0.2] / ±1'
SCALE DRAWING NOT TO SCALE



DRAWING NUMBER
34-RW42D1100

DATE
DECEMBER 9, 2009

REVISION
B



RW42D1100

