

4

3

2

1

THIS DRAWING IS UNPUBLISHED. RELEASED FOR PUBLICATION  
 © COPYRIGHT 19 BY TYCO ELECTRONICS CORPORATION. ALL RIGHTS RESERVED.

LOC	DIST	REVISIONS				
P	LTR	DESCRIPTION	DATE	DWN	APVD	
FX	00					
	0	RELEASED PER EC# OK80-0283-02	06JAN2003	SPT	AME	
	A	REV PER EC OK80-0461-04	17DEC2004	RDW	AME	
	AI	REV PER ECR-10-011823	28MAY2010	VSS	CS	

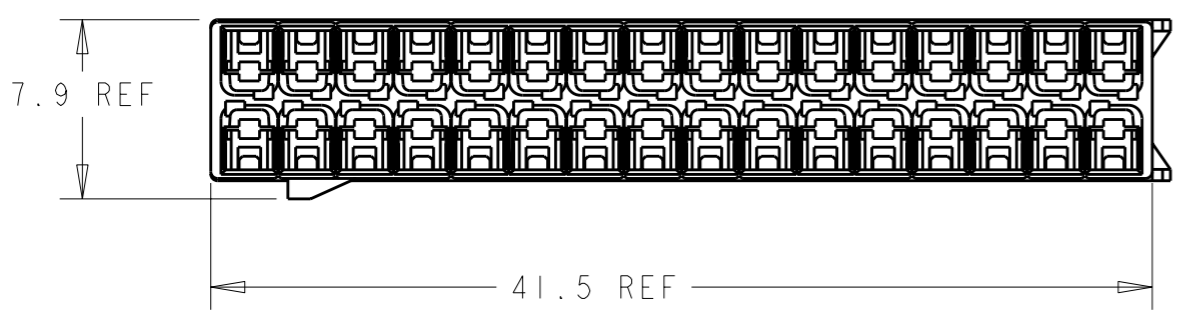

- 1 MATERIAL: GLASS FILLED NYLON.
- 2. RECEPTACLES SOLD SEPARATELY, SEE P/N 638551 (TIN) OR 1326028 (GOLD) FOR TERMINATION AND REELING OPTIONS.
- 3. REFER TO INSTRUCTION SHEET 408-8662 FOR PRODUCT ASSEMBLY AND DISASSEMBLY PROCEDURES.
- 4. REFER TO USCAR-2 REV 3 APRIL 2001 FOR PRODUCT SPECIFICATIONS.

COMPANY LOGO

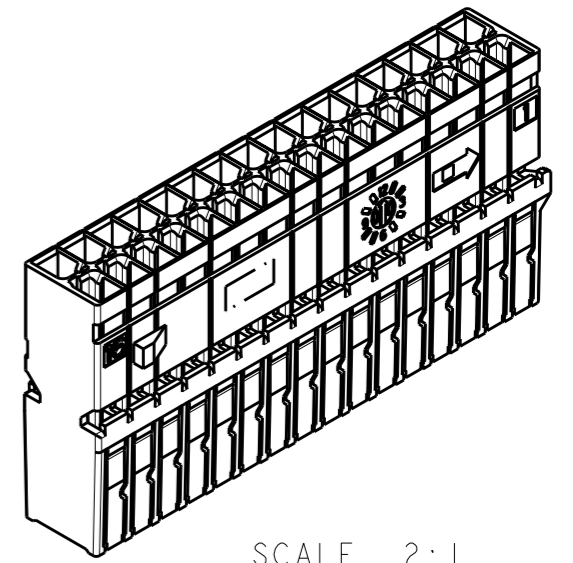
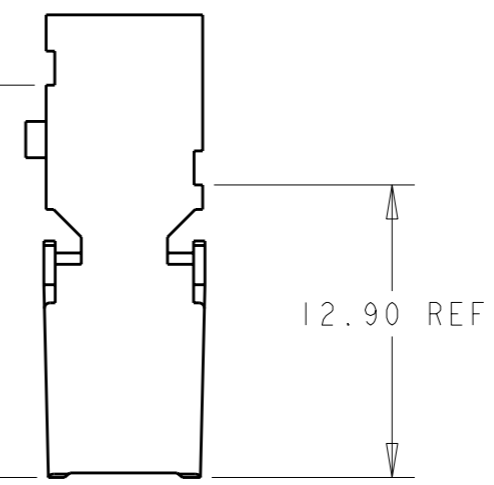
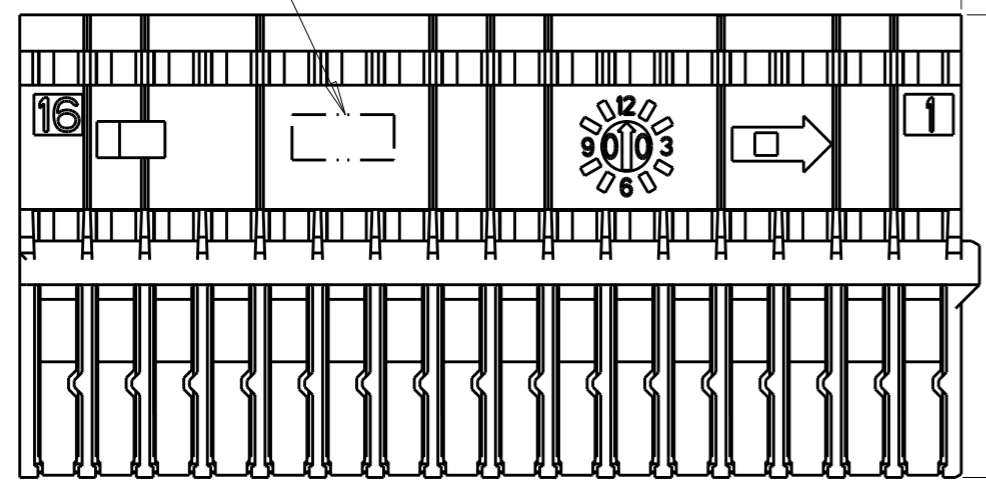

CARRIER ENVELOPE

32X Ø0.70 MAX  
 $\oplus 0.05 \text{ (M)}$  B A C

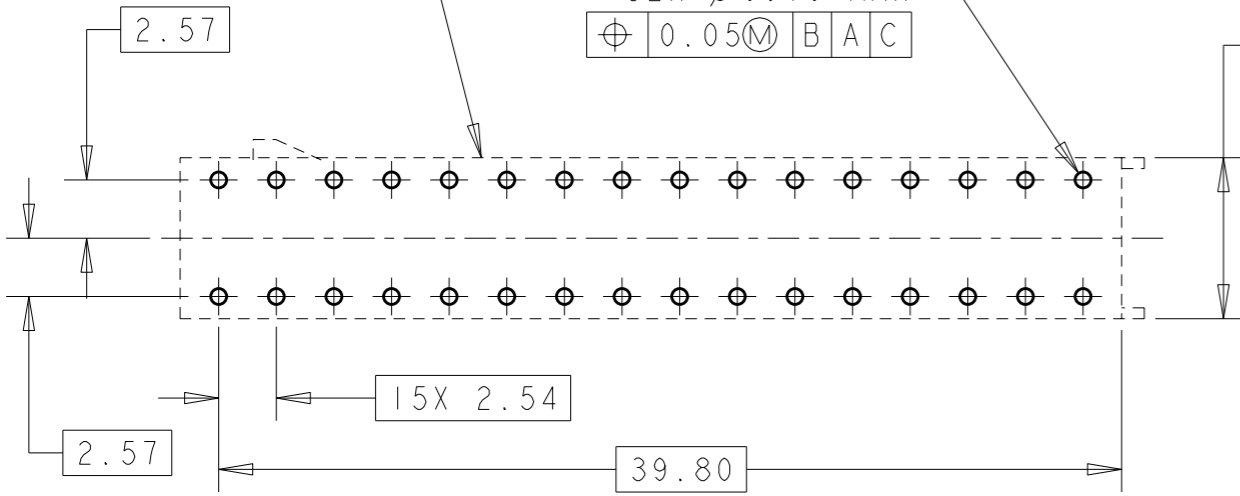

PROBE PIN RECOMMENDED LAYOUT

THIS DRAWING IS A CONTROLLED DOCUMENT FOR TYCO ELECTRONICS CORPORATION. IT IS SUBJECT TO CHANGE AND THE CONTROLLING ENGINEERING ORGANIZATION SHOULD BE CONTACTED FOR THE LATEST REVISION.

DIMENSIONS:	TOLERANCES UNLESS OTHERWISE SPECIFIED:
MM	
0 PLC	±-
1 PLC	±0.1
2 PLC	±0.05
3 PLC	±-
4 PLC	±-
ANGLES	±-

MATERIAL: - FINISH: -

DWN	W. HOELSCHER	07NOV01
CHK	S. TOBEY	07NOV01
APVD	S. TOBEY	07NOV01
PRODUCT SPEC	-	-
APPLICATION SPEC	-	-
WEIGHT	-	-

BLACK	A	1326227-1
COLOR	KEY	PART NO.
AMP Incorporated Harrisburg, PA 17105-3608		
NAME: RECEPTACLE HOUSING, 32 POSITION 0.64mm, LAC		
SIZE	CAGE CODE	DRAWING NO
A3	00779	1326227
CUSTOMER DRAWING		RESTRICTED TO
SCALE 3:1		SHEET 1 OF 1 REV AI