

## Housing - HC-B 16-KMQ-H-O1M32 - 1460181

Please be informed that the data shown in this PDF Document is generated from our Online Catalog. Please find the complete data in the user's documentation. Our General Terms of Use for Downloads are valid (<http://download.phoenixcontact.com>)



HEAVYCON B16 coupling housing, with double locking latch, height: 82 mm, with 1 x M32 gland, straight cable outlet



### Key commercial data

|                      |          |
|----------------------|----------|
| Packing unit         | 1 pc     |
| Custom tariff number | 85389099 |
| Country of origin    | Germany  |

### Technical data

#### Dimensions

|        |       |
|--------|-------|
| Height | 82 mm |
| Width  | 43 mm |
| Length | 94 mm |

#### Ambient conditions

|                                 |                   |
|---------------------------------|-------------------|
| Ambient temperature (operation) | -40 °C ... 125 °C |
|---------------------------------|-------------------|

#### General

|                              |  |
|------------------------------|--|
| Note                         | For contact inserts HC-B16, BB32, D40, DD72, HS6, M, K |
| Design                       | B16  |
| Housing type                 | Coupling housings                                      |
| Locking type                 | With double locking latch                              |
| No. of cable exits           | 1  |
| Cable exit                   | Straight   |
| Screw connection             | None   |
| Type of the screw connection | 1x M32   |
| Housing material             | Aluminum die-cast                                      |
| Housing surface material     | Powder-coated, gray                                    |

# Housing - HC-B 16-KMQ-H-O1M32 - 1460181

## Technical data

### General

|                              |                                     |
|------------------------------|-------------------------------------|
| Seal material                | NBR                                 |
| Material lock                | Stainless steel, handle: PA         |
| Material grip body interlock | PA                                  |
| Assembly instructions        | For half and full screw connections |

## Classifications

### eCl@ss

|            |          |
|------------|----------|
| eCl@ss 4.0 | 27140816 |
| eCl@ss 4.1 | 27140816 |
| eCl@ss 5.0 | 27143424 |
| eCl@ss 5.1 | 27143424 |
| eCl@ss 6.0 | 27143424 |
| eCl@ss 7.0 | 27440209 |
| eCl@ss 8.0 | 27440209 |

### ETIM

|          |          |
|----------|----------|
| ETIM 3.0 | EC000437 |
| ETIM 4.0 | EC000437 |
| ETIM 5.0 | EC000437 |

### UNSPSC

|               |          |
|---------------|----------|
| UNSPSC 6.01   | 31261502 |
| UNSPSC 7.0901 | 31261502 |
| UNSPSC 11     | 31261502 |
| UNSPSC 12.01  | 31261502 |
| UNSPSC 13.2   | 31261502 |

## Drawings

# Housing - HC-B 16-KMQ-H-O1M32 - 1460181

Dimensioned drawing

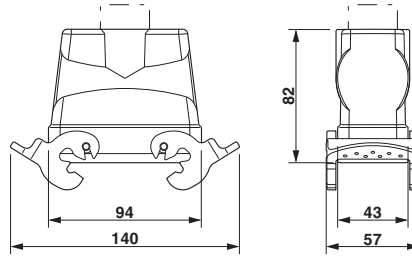

Dimensional drawing