

ITEM	QTY	PART NUMBER	DESCRIPTION
1	1	F051601	P16 PLASTIC TERMINAL PROTECTOR
2	1	F050421	50-004-21 12V YEL LED
3	1	F040011	P16EES11
4	1	F050306	50-003-06 CONCAVE YEL LENS

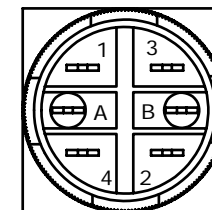

PANEL MOUNTING

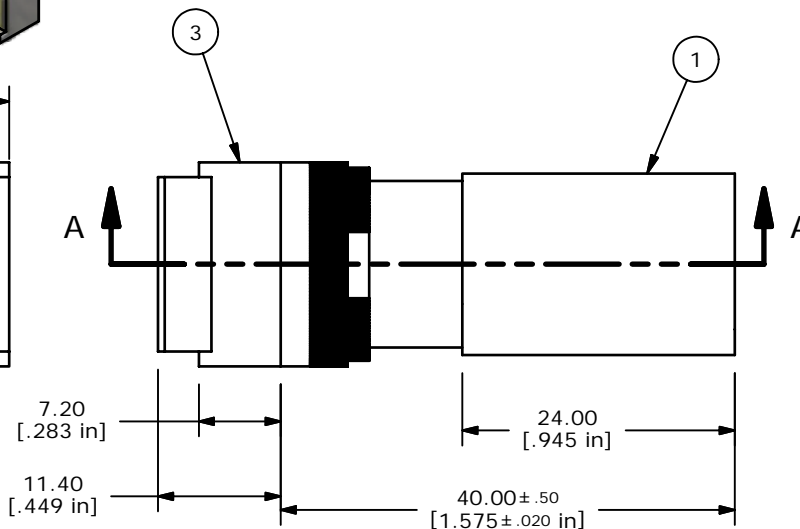
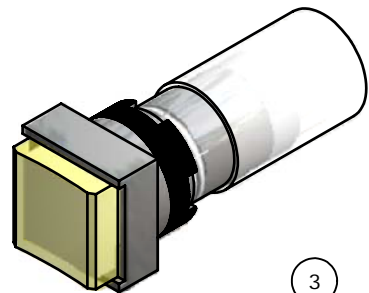
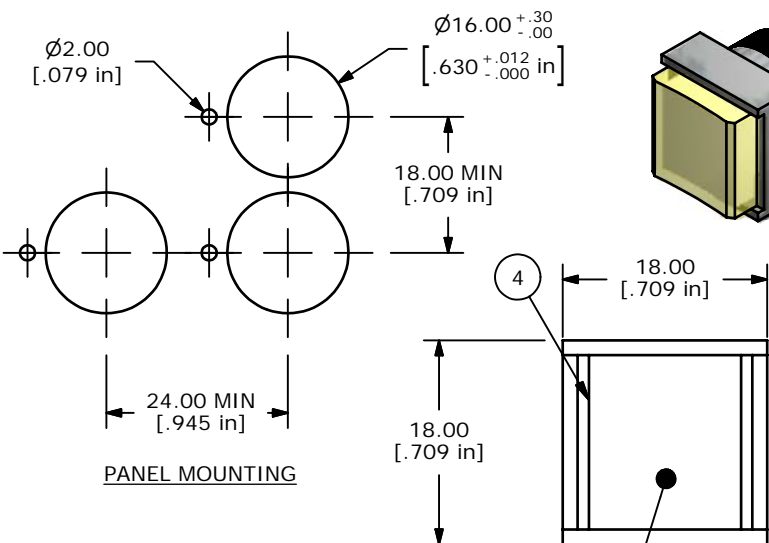
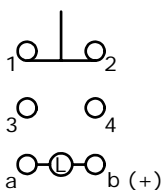

CONTACT CONFIGURATION

- NOTE:
- ALL DIMENSIONS IN MM [INCH]
  - GENERAL TOLERANCE: X.X=±0.4  
X.XX=±0.25
  - TERMINAL NUMBERS FOR REF ONLY
  - CONTACT RATING: 5A@ 250VAC  
6A@ 24VDC
  - ELECTRICAL LIFE: 50,000 OPERATIONS
  - INSULATION RESISTANCE: 1,000 MEGA-OHM MIN.
  - OPERATING TEMP.: -25°C to 55°C
  - ▲ LAMP VOLTAGE: 12VDC LED
  - ▲ DENOTES CRITICAL PARAMETER.
  - PACKAGE: BOX/20 PCS
  - 2002/95/EC (ROHS) COMPLIANT

SECTION A-A  
SCALE 1.50 : 1



A	17278	RELEASED FOR PRODUCTION	5/14/07	TN
REV	PCR NO	DESCRIPTION	DATE	BY

TITLE P16EES11JYELYEL				
SCALE	DATE	DR	DWG	REV
2:1	5/14/2007	TN	XF0719P	A

THE INFORMATION CONTAINED IN THIS DOCUMENT IS PROPRIETARY TO E-SWITCH AND IS NOT TO BE COPIED OR TRANSFERRED