

- NOTES:
- MATERIAL:
    - BRASS.
    - PHOS. BRONZE.
  - PLATING:
 

.000100/ (.00254) MIN. TIN OVER .000050/ (.00127) MIN. NICKEL (POST-PLATE).
  - PRODUCT SPECIFICATION: PS-5556-001, PS-5556-002, PS-5556-003
  - PACKAGING SPECIFICATION: PK-5558-001 FOR REELS  
PK-5556-003 FOR LOOSE
  - MATES WITH TERMINAL: 5556 SERIES
  - TERMINAL IS FOR USE WITH MOLEX PLUG HOUSINGS 5559, 30068, AND 42475.
  - THE NUMBER OF SERRATIONS TO BE ONE FOR WIRE RANGE 22-28.
  - MEASURING POINT FOR PLATING THICKNESS.
  - WHEN TERMINALS ARE INSTALLED IN THE HOUSING THE WIRES ARE TO BE DRESSED IN SUCH A MANNER TO ALLOW THE TERMINALS TO FLOAT FREELY IN THE POCKET.
  - THIS TERMINAL IS DESIGNED FOR SINGLE WIRE CRIMPING.
  - PART CONFORMS TO CLASS 'B' REQUIREMENTS OF COSMETIC SPECIFICATION PS-45499-002.

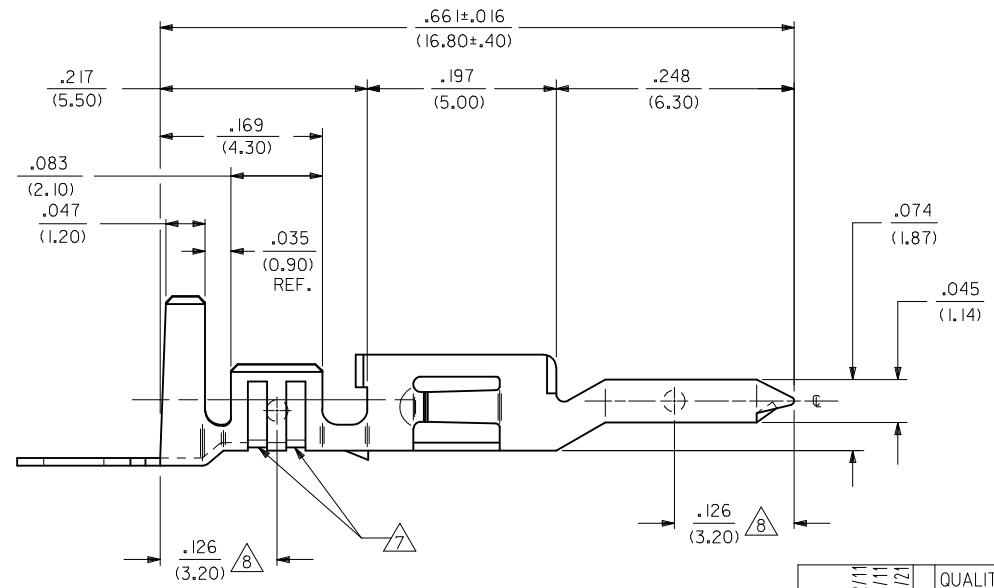
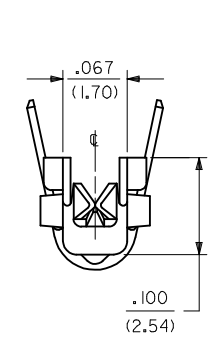
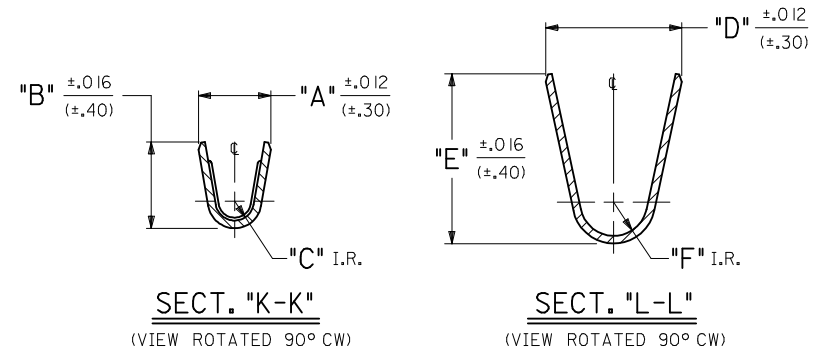

<b>UPDATE NOTES</b> EC NO: UCP2014-3293 DRWINGUYEN 2014/02/11 CHKD:JBELL 2014/02/11 APPR:FSMITH 2014/03/21	QUALITY SYMBOLS 	GENERAL TOLERANCES (UNLESS SPECIFIED)		DIMENSION STYLE <b>IN/MM</b>	SCALE <b>INCH</b>	DESIGN UNITS <b>INCH</b>	THIRD ANGLE PROJECTION	
		4 PLACES ± --- ± --- 3 PLACES ± --- ± .010 2 PLACES ± .25 ± .015 1 PLACE ± .38 ± --- 0 PLACE ± --- ± ---	mm INCH DRAWN BY NGUYEN CHECKED BY GEP APPROVED BY FSMITH DATE 2014/02/11 DATE 1992/05/12 DATE 2014/03/21	TITLE <b>MALE CRIMP TERMINAL WITH TIN-OVER-NICKEL PLATING. (MINI-FIT JR. SERIES)</b>	MATERIAL NO. <b>SEE SHEET 2</b>	DOCUMENT NO. <b>SD-5558-*S*</b>	SHEET NO. <b>1 OF 2</b>	
		ANGULAR ±1/2°		DRAFT WHERE APPLICABLE MUST REMAIN WITHIN DIMENSIONS		<b>molex</b>		
		THIS DRAWING CONTAINS INFORMATION THAT IS PROPRIETARY TO MOLEX. INCORPORATED AND SHOULD NOT BE USED WITHOUT WRITTEN PERMISSION						

PART NO.	ENG. NO.	FORM	MAT'L.	WIRE GAGE	RANGE OF INSULATION DIA.	QUANTITY PER REEL (FORMED)	DIM. "A"	DIM. "B"	DIM. "C"	DIM. "D"	DIM. "E"	DIM. "F"			
39-00-0120	5558-S	CHAIN	A	18-24 GA.	.051-.122 (1.30-3.10)	4,000	.075 (1.90)	.091 (2.30)	.020 (.50)	.142 (3.60)	.177 (4.50)	.035 (.90)			
39-00-0121	5558-SL	LOOSE		22-28 GA.	.035-.071 (.90-1.80)	6,000	.071 (1.80)	.065 (1.65)	.016 (.40)	.091 (2.30)	.091 (2.30)	.024 (.60)			
39-00-0122	5558-S2	CHAIN			16 GA.	.122 (3.10) MAX.	4,000	.091 (2.30)	.106 (2.70)	.024 (.60)	.142 (3.60)	.177 (4.50)	.035 (.90)		
39-00-0123	5558-S2L	LOOSE				B	.051-.122 (1.30-3.10)	4,000	.075 (1.90)	.091 (2.30)	.020 (.50)	.142 (3.60)	.177 (4.50)	.035 (.90)	
39-00-0124	5558-S3	CHAIN					22-28 GA.	.035-.071 (.90-1.80)	6,000	.071 (1.80)	.065 (1.65)	.016 (.40)	.091 (2.30)	.091 (2.30)	.024 (.60)
39-00-0125	5558-S3L	LOOSE						16 GA.	.122 (3.10) MAX.	4,000	.091 (2.30)	.106 (2.70)	.024 (.60)	.142 (3.60)	.177 (4.50)
39-00-0126	5558-PBS	CHAIN	A						.051-.122 (1.30-3.10)	4,000	.075 (1.90)	.091 (2.30)	.020 (.50)	.142 (3.60)	.177 (4.50)
39-00-0127	5558-PBSL	LOOSE		22-28 GA.					.035-.071 (.90-1.80)	6,000	.071 (1.80)	.065 (1.65)	.016 (.40)	.091 (2.30)	.091 (2.30)
39-00-0128	5558-PBS2	CHAIN			16 GA.				.122 (3.10) MAX.	4,000	.091 (2.30)	.106 (2.70)	.024 (.60)	.142 (3.60)	.177 (4.50)
39-00-0129	5558-PBS2L	LOOSE				B			.051-.122 (1.30-3.10)	4,000	.075 (1.90)	.091 (2.30)	.020 (.50)	.142 (3.60)	.177 (4.50)
39-00-0130	5558-PBS3	CHAIN					22-28 GA.		.035-.071 (.90-1.80)	6,000	.071 (1.80)	.065 (1.65)	.016 (.40)	.091 (2.30)	.091 (2.30)
39-00-0131	5558-PBS3L	LOOSE						16 GA.	.122 (3.10) MAX.	4,000	.091 (2.30)	.106 (2.70)	.024 (.60)	.142 (3.60)	.177 (4.50)

**LEGEND:**

5558-\*\*\*S\*\*

BASE NO. \_\_\_\_\_  
MATERIAL \_\_\_\_\_  
    BLANK= BRASS  
    PB= PHOS. BRONZE  
    S= TIN OVER NICKEL  
CRIMP SIZE \_\_\_\_\_  
    BLANK = 18-24 AWG  
    2 = 22-28 AWG  
    3 = 16 AWG  
CHAIN OR LOOSE \_\_\_\_\_  
    BLANK= CHAIN  
    L= LOOSE

SEE SHEET 1 EC NO: UCP2014-3293 DRAWN: NGUYEN 2014/02/11 CHKD: BELL 2014/02/11 APPR: FSMITH 2014/03/21	QUALITY SYMBOLS ▽=0 ▽=0 ▽=0	GENERAL TOLERANCES (UNLESS SPECIFIED)		DIMENSION STYLE IN/MM		SCALE 1:1	DESIGN UNITS INCH	THIRD ANGLE PROJECTION	
				mm	INCH	DRAWN BY NGUYEN		DATE 2014/02/11	
		4 PLACES ± ---		± ---		CHECKED BY GEP		DATE 1992/05/12	
		3 PLACES ± ---		± .010		APPROVED BY FSMITH		DATE 2014/03/21	
2 PLACES ± .25		± .015		MATERIAL NO.		DOCUMENT NO.		SHEET NO.	
1 PLACE ± .38		± ---		SEE CHART		SD-5558-*S*		2 OF 2	
0 PLACE ± ---		± ---		DRAFT WHERE APPLICABLE MUST REMAIN WITHIN DIMENSIONS		THIS DRAWING CONTAINS INFORMATION THAT IS PROPRIETARY TO MOLEX INCORPORATED AND SHOULD NOT BE USED WITHOUT WRITTEN PERMISSION			