

37	69.32	63.50	55.68	54.71	49.68
25	53.03	47.04	39.12	38.25	33.12
15	39.14	33.32	25.18	24.54	19.18
09	30.81	24.99	16.96	16.21	10.96
SHELL	A	B	C	D	E

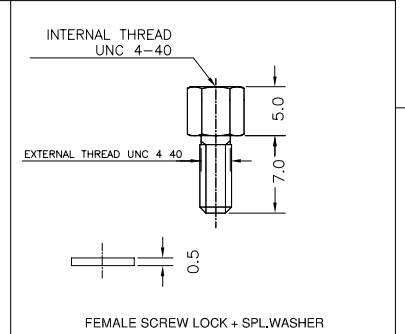
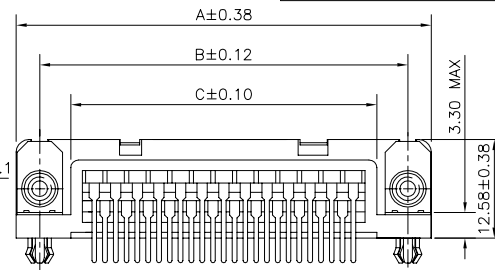
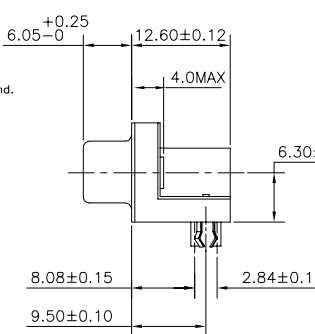
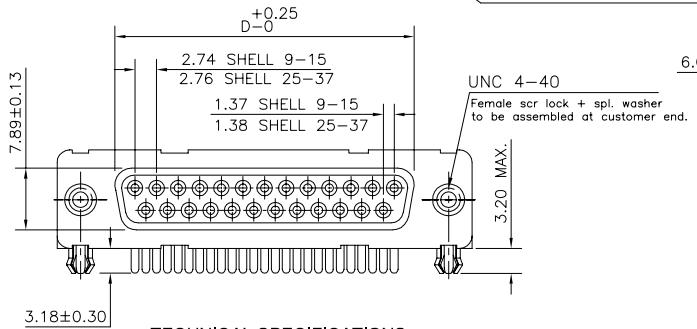
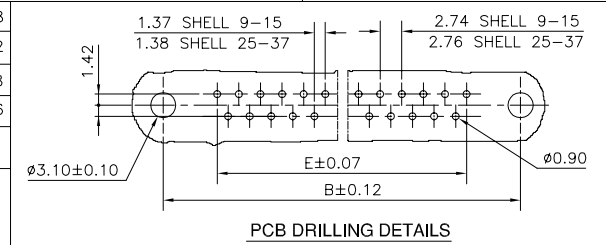

TECHNICAL SPECIFICATIONS

MATERIAL

- SHELL : STEEL TIN/Zinc Cr 3 PLATED.
- INSULATORS : SELF EXTINGUISHING BLACK POLYESTER UL CLASS 94V0
THE HOUSING WILL WITHSTAND EXPOSURE TO 260-265°C
IF WE USE PROTECTIVE ADHESIVE (type Kapton or Teflon)
OR PROTECTIVE METALLIC DEVICE
- CONTACTS : COPPER ALLOY
- PLATING : GXT/GOLD OVER NICKEL
- ACTIVE ZONE : TIN LEAD OVER NICKEL
- TERMINATION ZONE : 2μ MIN.MATTE TIN TOP OVER
1.27μ MIN.NICKEL UNDER PLATE(ON TERMINATION ZONE)
- FOR LEAD FREE PLATING : BRASS,TIN/Zinc Cr 3 PLATED.
- METAL BRACKET : BRASS,TIN PLATED.
- HARPOON : BRASS,TIN PLATED.
- CLINCH NUT : BRASS,TIN/Zinc Cr 3 PLATED.
- SCREW LOCK : BRASS,TIN/Zinc Cr 3 PLATED.
- WASHER : BRASS,TIN/Zinc Cr 3 PLATED.

ELECTRICAL DATA

- MAX.CURRENT RATING : 5A
- TEST VOLTAGE : 1000V
- RATED VOLTAGE : 300V
- CONTACT RESISTANCE : ≤ 25mΩ
- SHELL RESISTANCE : ≤ 5mΩ
- INSULATION RESISTANCE : ≥ 5000M Ω

ENVIRONMENTAL CHARACTERISTICS.

- OPERATING TEMPERATURE RANGE : -55°C +125°C

MECHANICAL CHARACTERISTICS

- MATING/UNMATING CYCLES (MIN) : 200 (PLATING CODE:4); 500 (PLATING CODE:8)
- INSERTION/EXTRACTION FORCE PER CONTACT : 5 N Max./ 0.3 N Min.

ORDERING INFORMATION

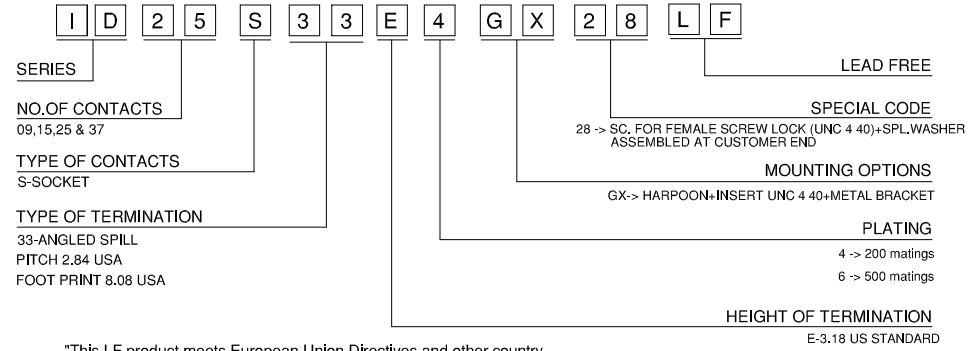

"This LF product meets European Union Directives and other country regulations as described in GS-22-008"

The housing will withstand exposure to 260°C peak temperature for 3.5 seconds in a wave solder application with a 1.6mm minimum thick circuit board.

Packaging as per GS-14-920

mat'l. code		surface		tolerance		projection		product family	
SEE NOTE 4		ISO 1302		ISO 406 ISO 1101		MM		DELTA-D	
ltr	ecn no	dr	date	tolerances unless otherwise specified		title		DELTA-D A/S FEMALE CONNECTOR	
E	106-0074	GVJ	2006/06/08	angles	linear	scale		(GX VER.)+ SCREW FOR FEM.SCREW LOCK+WASHER	
F	111-0124	RPK	2011-06-18	0°±1°					
		dr	GEORGE.V.JOSEPH	16/12/1998		sheet 1 of 1		size	
		enr	GEORGE.V.JOSEPH	16/12/1998		C-DD-0019		A3	
		chr	NIRMAL.G	2010-06-28		type		Product Customer Drawing	
		appd	SUDHIR.V	2010-06-28					
sheet index	revision sheet	F	1						



Copyright FCI