

	13	12	11	10	9	8	7	6	5	4	3	2	1				
J	PART NO..	ENG. NUMBER	TERMINAL LOCATION (SEE CHART)	MAT'L	PEG TYPE	PLATING (SEE CHART)	DIA. "A"		TERMINAL LOCATION CHART (M=MALE, F=FEMALE, B=BLANK)			PLATING		J			
	10-18-1031	A-3099-P3	A	V-0	POLARIZING	B	$.100 \pm .005$ (2.54 ± 0.13)		TERMINAL LOCATION CHART (M=MALE, F=FEMALE, B=BLANK)		A	UNPLATED			I		
	10-18-1032	A-3099-P3I	B		POLARIZING				TERMINAL LOCATION CODE	CIRCUIT NO.		I	2			3	PINS ONLY: OVERALL TIN: .000200/(0.00508) MIN. OVER COPPER .000100/(0.00254) MIN.
	10-18-1033	A-3099-P3A	C		POLARIZING				A	M	B	M	SOCKETS ONLY: OVERALL TIN: .000050/(0.00127) MIN. OVER NICKEL .000050/(0.00127) MIN.				
	10-18-1034	A-3099-P3B	D		POLARIZING				B	M	M	M					
	10-18-1035	A-3099-P3C	E		POLARIZING				C	F	M	M					
	10-18-1036	A-3099-P3D	F		POLARIZING				D	M	F	M					
	10-18-1037	A-3099-P3H	G		POLARIZING				E	M	M	F					
	10-18-1038	A-3099-P3E	H		POLARIZING				F	M	F	B					
38-00-0204	A-3099-P3I3	B		NONE		G	M	F	F								
H	22-19-1031	A-3099-030I	A	↓	LOCKING	↓	$.103 \pm .003 / - .002$ (2.62 ± 0.08 / - 0.05)		H	F	F	F		H			

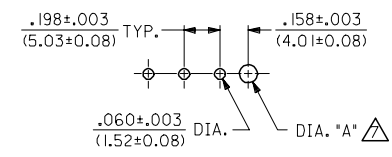
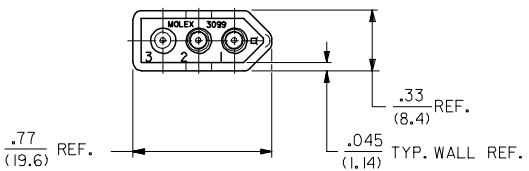
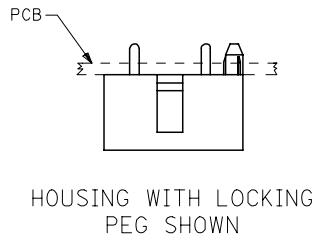
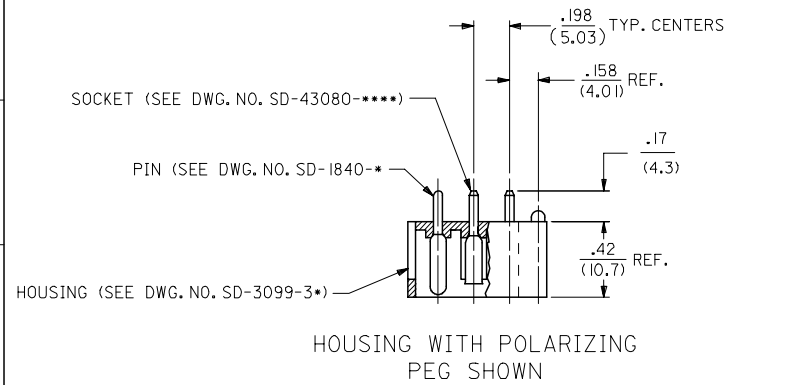

RECOMMENDED P.C. BOARD HOLE LAYOUT

- NOTES:
- MATERIAL:  
HOUSING: UNFILLED POLYESTER, 94V-0, COLOR: BLACK  
PIN TERMINAL: CARTRIDGE BRASS  
SOCKET TERMINAL: PHOSPHOR BRONZE
  - FINISH: SEE TABLE
  - PRODUCT SPECIFICATION: N/A
  - PACKAGING SPECIFICATION: N/A
  - MATES WITH MOLEX 1396 RECEPTACLES AND .093/(2.36) SERIES TERMINALS.
  - ASSEMBLIES TO BE MOUNTED ON SUPPORTED EDGE OF P.C. BOARD.
  - ONLY REQUIRED WHEN USING PARTS WITH OPTIONAL POLARIZING OR LOCKING PEGS.

UPDATE PLATING FC NO: UCP2006-2825 DRAWN: P. DDER 2006/06/08 CHKD: AEL/HAG 2006/06/09 APPR: FSM/TH 2006/06/12	QUALITY SYMBOLS =0 =0	GENERAL TOLERANCES (UNLESS SPECIFIED)		DIMENSION STYLE		SCALE	DESIGN UNITS	THIRD ANGLE PROJECTION	
		mm	INCH	IN/MM		2:1	INCH		
J1	DESCRIPTION	4 PLACES	± .010	± .010	DRAWN BY	DATE	CONNECTOR ASSEMBLY ENCLOSED WAFER 3 CIRCUIT		
		3 PLACES	± .010	± .010	GEP	5/25/89			
		2 PLACES	± 0.25	± .014	CHECKED BY	DATE			
		1 PLACE	± 0.36	± .014	RW	5/25/89			
ANGULAR ±1/2°		APPROVED BY		DATE	MATERIAL NO.		DOCUMENT NO.		SHEET NO.
DRAFT WHERE APPLICABLE MUST REMAIN WITHIN DIMENSIONS		RAS		5/25/89	SEE CHART		SDA-3099-*3**		1 OF 1
THIS DRAWING CONTAINS INFORMATION THAT IS PROPRIETARY TO MOLEX INCORPORATED AND SHOULD NOT BE USED WITHOUT WRITTEN PERMISSION									